

Technical data: MONOVAC / SUPERVAC vacuum valves

SWISS MADE



MONOVAC



SUPERVAC MINI



SUPERVAC MEDIO



SUPERVAC MAXI

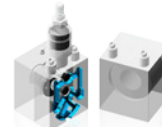

SUPERVAC MACRO

	MONOVAC		SUPERVAC MINI		SUPERVAC MEDIO		SUPERVAC MAXI		SUPERVAC MACRO	
Die casting machine tonnage (t)	400 – 3000		< 400 approx.		200 – 1200		800 – 2800		1600 – 4500	
CHARACTERISTICS										
Closing system	Controlled closure (by compression spring)		Closed by the kinetic energy of the metal		Closed by the kinetic energy of the metal		Closed by the kinetic energy of the metal		Closed by the kinetic energy of the metal	
Closing time (ms)	100		1		1		1		1	
SCOPE										
Al / Mg	■		■		■		■		■	
Zn	-		■		■		-		-	
Shot weight Al (kg)	4 – 25		0,3 – 1,5		1 – 12		6 – 25		12 – 45	
Shot weight Mg (kg)	3 – 17		0,07 – 1		0,7 – 8		4 – 16		8 – 30	
Shot weight Zn (kg)	-		0,2 – 4		3 – 20		-		-	
TECHNICAL DATA										
	Valve	Compensator	Valve	Compensator	Valve	Compensator	Valve	Compensator	Valve	Compensator
Width (mm)	130	130	63	63	100	100	140	140	150	150
Depth (mm)	100	80	63,4	63,5	88,9	88,9	108	108	139,7	139,7
Height (mm)	134	134	76	75	127	126	152	151	171	170
Weight (kg)	13	10,8	3	2,3	9,6	8,4	19	16,4	28,4	25,4

Patented worldwide